

Table of contents

- SFC Element 'Macro'

SFC Element 'Macro'

SFC Element 'Macro'

Symbol

A macro includes part of the SFC diagram, but it is not displayed in detail in the main view of the editor.

Using macros does not influence the processing flow. Macros are used for hiding specific parts of the diagram, for example to increase overall clarity.

You open the macro editor by double-clicking the macro box or by clicking SFC → Zoom Into Macro. You can program here just like in the main view of the SFC editor. To close the macro editor, click SFC → Zoom Out of Macro.

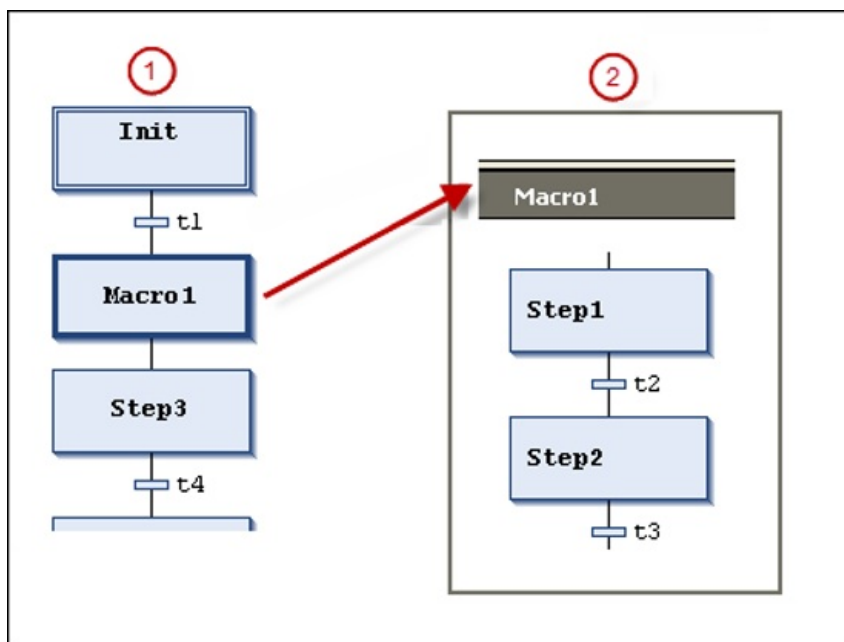

① Main view in the SFC editor

② Macro editor view for Macro1

Macros can also include other macros. The caption of the macro editor always shows the path of the open macro within the diagram, for example:

Macro1 -> Macro2



See also

- ↘ “Programming in SFC”
- ↘ “Command 'Zoom Into Macro'”
- ↘ “Command 'Zoom Out of Macro'”